

I hereby certify this map to be substantially correct

A.W.C. Kratzert
 A.W.C. KRATZERT
 CONN. P.E. & L.S. #137

LOT PLAN
 FOR
 LOTS - 60, 61, 74, & 75
 MILLODALE PARK
 MILLODALE AVE. SOUTHWINGTON, CONN.
 SCALE - 1" = 20' SEPTEMBER 1965

KRATZERT & JONES
 CIVIL ENGINEERS & LAND SURVEYORS
 176 N. MAIN ST. SOUTHWINGTON, CONN.



ZBA #6479A

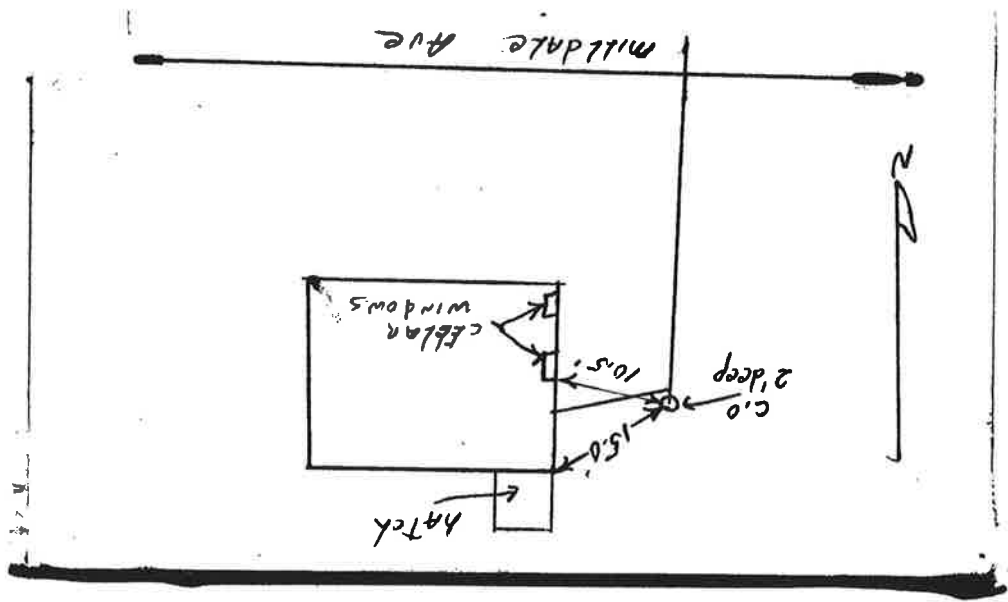

200

122 a 124 House #

Mildale Ave

Permit # 1257

Owner - George M. Sackeck

Drain Layer

Tied to sewer - Nov 5, 1965

Plumbing - Done

Inspector - Ed Rich